

FLUSH CUT PULL SAW

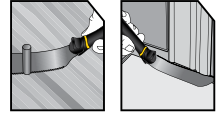

- Flexible blade for flush and finish cuts
- Quick-change blade to handle assembly
- Thin blade for cutting accuracy and clean finish
- Ergonomically designed cushion grip handle for comfort



SKU #	Description	Blade Length (in.)	Blade Length (mm)	TPI	Box Qty
20-500	Flush Cut Pull Saw	9"	229	15	4

12" BASIC HACKSAW



- Robust, all-metal frame for durability
- Full grip handle helps protect knuckles
- Compact frame for comfort and control
- Large tensioning knob for ease of use
- 90° and 180° adjustable blade angles allowing flush cuts

SKU #	Description	Blade Length (in.)	Blade Length (mm)	TPI	Box Qty
STHT20138	12" Basic Hacksaw	12"	305	24	6

MINI-HACK™ UTILITY SAW



- 15809 - Durable solid aluminum construction
- 20807 – Durable solid plastic construction
- Ideal for hard-to-reach places
- Handle covers blade to help protect user's hands

SKU #	Description	Blade Length (in.)	Blade Length (mm)	TPI	Box Qty
STHT15809-8	10" Metal Mini-Hack™ Utility Saw	10"	250	24	6
STHT20807-8	10" Mini-Hack™ Utility Saw	10"	250	24	6

COPING SAW



- Hardened, tempered provides clean, controlled cutting action
- 4 blades included
- Light weight wooden handle

SKU #	Description	Blade Length (in.)	Blade Length (mm)	Frame Depth (mm)	TPI	Box Qty
STHT15104-8	Coping Saw 120mm_4.75" Depth (4 blades)	6-1/2"	165	120	15	-
STHT15106-8	Coping Saw 170mm_6.75" Depth (4 blades)	6-1/2"	165	120	15	-